

ALL DRAWINGS AND SPECIFICATIONS ARE THE PROPERTY OF THE CONSULTANT.
 NO REPRODUCTIONS MAY BE MADE WITHOUT THE CONSENT OF THE CONSULTANT AND
 ALL REPRODUCTIONS MUST BEAR THE NAME OF THE CONSULTANT.
 THE CONTRACTOR SHALL VERIFY ALL DIMENSIONS, DATUMS AND LEVELS NOTED ON
 THE DRAWINGS WITH THE CONDITIONS ON SITE AND SHALL BE RESPONSIBLE FOR
 REPORTING ANY ERRORS OR OMISSIONS TO THE ENGINEER FOR ADJUSTMENTS.
 THIS DRAWING SHALL NOT BE SCALED.

LEGEND:
 - - - - - FURNITURE NOT IN CONTRACT

NOTES:
 THIS DRAWING IS FOR INFORMATION PURPOSES ONLY. FINAL
 LOCATION OF FIXTURES WILL BE DETERMINED BY OWNER.

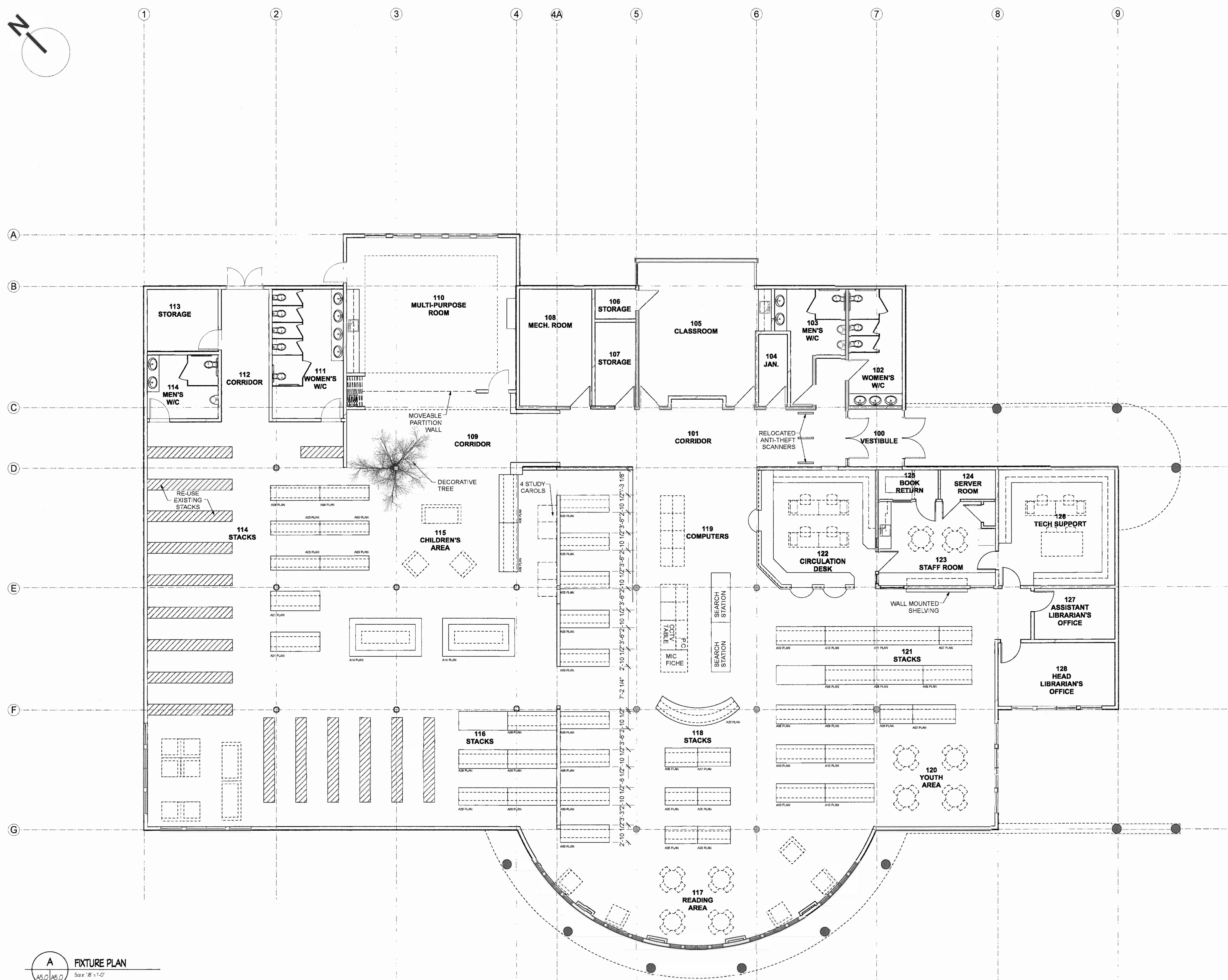

Revisions	
July, 2011	ISSUED FOR TENDER
June, 2011	ISSUED FOR 90% REVIEW
Date	Revision
Northern Sky Architecture Inc.	
103 - 120 Fort Street Winnipeg, Manitoba, Canada R2C 1C9 509.105.0818 ext. 101 Fax 204.936.7079 204.943.6767	

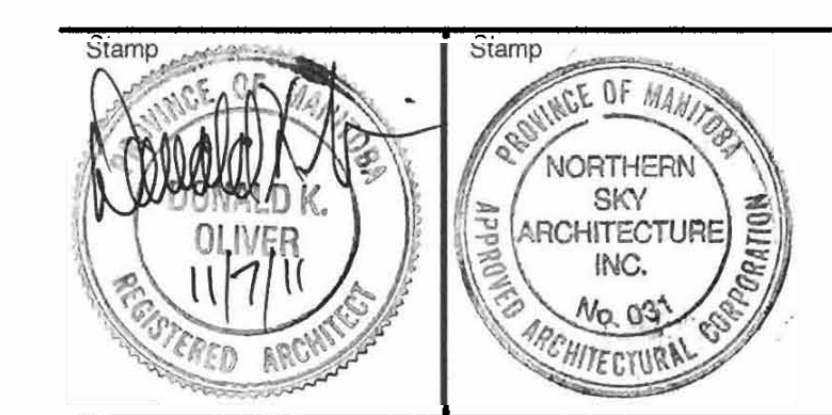

Project
Jake Epp Library Addition
 255 Elmdale Street
 Steinbach, Manitoba
 R5G 0C9

A FIXTURE PLAN
 A5.0 A5.0
 Size: 18" x 1'-0"

drawing title			
FIXTURE PLAN			
scale	as noted	designed by	kdw/j/s
date	July, 2011	drawn by	kdw/j/s
project no.	10.115	reviewed by	d/ko
reference no.	sheet	A5.0	REV.